



West Floral Park NEWSLETTER

WHERE NEIGHBORS TURN INTO FAMILY & FRIENDS

2013 MEMBERSHIP DRIVE

Please join us in making West Floral Park the place to live & play!

What a great year 2012 was for WFPNA! Thanks to generous membership donations and profits from our successful events, we were able to give back to the community on a larger scale than ever before and we were able to start planning for future donations and neighborhood projects.

- WFPNA donated \$1,000 to *Santiago School* and \$1,000 to *The Wooden Floor*
- West Floral Park residents donated foodstuff items on December 2 for the *Second Harvest Food Bank*. We collected several boxes of items through your generous donations.
- West Floral Park residents supported two families in the *Adopt a Family Holiday program* in December. Our generous support of these two families was impressive and ensured that they had a wonderful holiday.

WFPNA will keep this momentum going into 2013 through our neighborhood project planning and giving back efforts. We will continue to sponsor family and social events, produce our colorful newsletter, welcome new families with a gift, provide informative Association meetings, and make improvements to our neighborhood.

Open Garden Day in May has grown every year and our 2012 event was quite successful in showcasing our neighborhood and in raising money. Our social events were better than ever in 2012, and 2013 promises to be another exciting year for our social calendar. Through our historic preservation efforts, we were able to acquire much more WFP history and lore. Look for more this year! Progress was made in getting our non-profit status in 2012 and we are looking forward to finally getting this status in 2013.

February is membership drive month. While all West Floral Park residents are automatically members of the Association (dues are voluntary), your generous donations fuel our efforts. Having lived 42 years in my house, I treasure this neighborhood and city. Join today and please consider increasing the amount that you donated last year. We are a neighborhood that makes a difference and improves our city!

Thank you for your thoughtful donation of time and money!
Kay Housley, Membership Chairman

2013 Membership Drive

WFPNA works to maintain and improve our residents' lives, homes and property values through various endeavors. Your contribution makes our neighborhood stronger and better able to do more—please join us in making West Floral Park the place to live and play.

There are many options for voluntary membership donations. We hope that everyone is able to submit a voluntary donation to support our neighborhood. The Voluntary Membership Form is enclosed. Complete and send today!

Your Membership Donation Counts!

Through your voluntary membership donation, WFPNA is able to do the following:

- Provide a unified voice in the neighborhood and in the greater community of Santa Ana
- Sponsor and work on improvement projects that continue to augment the ambience, amenities, and value of our neighborhood. Major projects have included the acquisition of our sign toppers and event banners. Ongoing projects include maintenance of common areas, painting sign poles, and holiday decorating

- Inform residents of events and projects in our neighborhood through our website and quarterly newsletter, and alert residents to current neighborhood safety and welfare concerns as well as current neighborhood events through our email blasts. New this year is our very own WFPNA Facebook page
- Offer information about our unique homes and their architecture as well as compile a history of our neighborhood through our historic preservation committee
- Spotlight the beauty of our neighborhood through our annual Open Garden Day
- Welcome new people to our neighborhood through our welcome gifts and new neighbor cocktail hours
- Reach out to the greater community through our “giving back” projects and donations
- Plan social and outreach events where stronger relationships can be built among neighbors. These events include:
 - Easter Egg Hunt Event (financial support to Families of Floral Park)
 - Wine Walk
 - Progressive Dinner
 - July 4th Parade
 - Senior Tea
 - Golf Tournament
 - Summer Concert (in conjunction with neighboring associations)
 - Oktoberfest
 - Holiday Party

Open Garden Day is Saturday, May 18

Have you ever considered opening your garden for this special day in our neighborhood?

Contact Donna Layne at 714-836-9777 for more information.

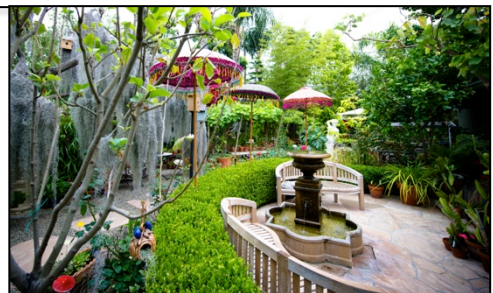

2012 Donating Households

Allan Price
 Allyn Enke
 Andy & Katie Sutton
 Bert & Mary Slezinger
 Bill & Carolyn Hogan
 Bill Korlowicz & Sharon Upham
 Bob & Jill Lee
 Brett & Rossette Franklin
 Brian Dawson
 Bruce Bauer
 Bryan & Mary Lang
 Cathie and Steven Fryer
 Christy Benson
 Chuck & Ann Winkler
 Cynthia Shotwell
 Dale & Jo Meredith
 Dan & Tracy Edmunds
 David Booth
 David Hartman
 Dennis Heathcock & Melinda Jordan
 Diana Janzen & Richard Evans
 Dianne Jeffries
 Dick & Buffie Politiski
 Don & Carolyn Honer
 Donald Bridinger
 Donna & Allen Layne
 Doug & Laura Jagerman
 Douglas Engelman
 Ed Flohra & Juan Hernandez

Elaine & Helen Ceja
 Eleanor Zimmer
 Evelyn Riedel
 Fred Horn & Carolyn Kirkwood
 Gaylene Galliford
 George & Kathleen Weir
 Glenn & Debra Lawler
 Gordon & Ann Niedringhaus
 Grace Yacoub & Mary Anne Carlson
 Greg & Gail West
 Haydee Vandendriessche
 James & Charlene Guerami
 James & Katherine Housley
 Jason & Jennifer Saenz
 Jim & Joan Theis
 Jim & Karen Mittendorf
 Jim & Vicki Bright
 John Waldo & Scott Lohse
 Jonathan & Samantha Stark
 Joseph & Michelle Chatelle
 Joyce Brown
 Juan & Victoria Gutierrez
 Kathryn & Patrick McLarney
 Kim Wright & Shawn Cunningham
 Kimberly Jones
 Linda & Tom McFarland
 Loretta Sanchez & Jack Einwechter
 Lynette Perry

Margaret Pashko
 Marty & Roger Morris
 Mary Kelly
 Mary Majors
 Michael & Stephanie Metzler
 Michael & Anna Tsai
 Mike & Kathi McLean
 Mitch & Darlene Wolfe
 Nick & Neva Klaassen
 Phil & Laurie Schaefer
 Postcards & Cards
 Ralph & Barbara Pagter
 Ricardo & Judith Romero
 Richard Austin & Ana Gomez
 Rick & Brenda Johnson
 Rick & Teresa Wagner
 Rick Amborski & Mel Steiner
 Rodolfo & Sarai Vela
 Ruth Honer
 Samuel Nunez
 Santa Ana Realty
 Sisters of St. Joseph of Orange
 Sonia Wegge
 Steve & Judith Tancredi
 Steve Simon
 Steven A. Mendoza
 Stuart & Silvia Fuller
 Thomas Walker
 Wilford & Jean Michael

Help Us Out—Become Part of Our Distribution Team!

Several times a year a team of dedicated volunteers passes out our newsletters and flyers. We are in need of more people to do this job. Volunteers usually are called upon 4-8 times per year to pass out our newsletters and flyers. This takes about 30 minutes per distribution. Routes are assigned to each member of the team. Contact Donna Layne at a.layne@sbcglobal.net if you want to join this crucial team.

Thank You to Our WFPNA Newsletter Advertisers

This newsletter would not be possible without the support of our generous advertisers. WFPNA is proud to offer advertising space to a wide variety of notable individuals and organizations in and near our community. Our 2012 corporate advertisers included:

- Richard J. Politiski, Attorney at Law
- The Nichole Doughty Real Estate Group
- CTA Travel
- Phil Schaefer, Seven Gables Real Estate
- Knightsbridge Asset Management

The WFPNA Newsletter reaches more than 650 homes in our neighborhood. The newsletter is available on the WFPNA Website year round for year-after-year viewing. Reach out to WFP neighbors and advertise! Ads and/or ad inserts will appear in our Spring, Summer and Fall newsletters, as well as on the Website with each newsletter. Please contact Donna Layne with any questions at a.layne@sbcglobal.net or 714.836.9777.

“In the Know” with WFPNA!

The WFPNA email blast is a crucial communication link to neighborhood news and events as well as important city information. Email blasts are sent out twice monthly or on an *as needed* basis. To be “In the Know,” send us your email contact information and we will add you to our list.

- Email a.layne@sbcglobal.net
- In the subject line of your email type: *WFPNA Add Me to Your List*
- Include your name and email in the body of the message

Our Facebook page is a more informal, day-to-day, interactive page on happenings in/around our neighborhood. Search for “West Floral Park Neighborhood” on Facebook and ask to join.

WFPNA Elected Board

President

Juanita Galliford
Juanita1151@hotmail.com

Vice President

Kay Housley
Kayhousley@att.net

Secretary

Tracy Edmunds
4.edmunds@gmail.com

Treasurer

Gaylene Galliford
gggalliford@hotmail.com

Beautification Chairs

Mel Steiner
melsteinergr@gmail.com
Nichole Doughty
nicholendg@gmail.com

Communications Chair

Donna Layne
a.layne@sbcglobal.net

Historic Preservation Chair

Jack Waldo
jcw13@msn.com

Members at Large

Rolando Chavez
Rolandoandtara@gmail.com
Maggie Miller
magmmiller@hotmail.com

Social Chairs

Karen Mittendorf
mittclan@pacbell.net
Melinda Jordan
mindyjordan2004@yahoo.com



WFPNA Pumpkin Weigh-In Winners



WFPNA Holiday Party